

External power supplies

AC/DC Single Output Desk top Type

80~100 Watts Max.

EA1095 Series



Features

- Active PFC Function
- CEC level VI
- RoHS compliance
- IEC320 C14
- Over voltage and over current protection
- Over temperature and short circuit protection
- Short circuit protective installation
- LED indication
- MTBF: >30,000 hours

Electrical Specifications

MODEL OUTPUT	VOLTAGE (Vo)	MIN. LOAD (Lo)	MAX. LOAD (Lo)	LOAD REGULATION	LINE REGULATION	RIPPLE & NOISE
EA10951C(N09)	12V	0	7.0A	+/- 5%	+/- 1%	1.5%

NOTE:
 1: Ripple & noise is measured by using 20MHz bandwidth limited oscilloscope and terminated each output with a 0.1uf ceramic capacitor & parallel with 47uF aluminum capacitor at full load and nominal line.
 2: Line regulation is defined by changing $\pm 10\%$ of input voltage from nominal line at rated load.

Electrical Specifications

Mechanical Specification

INPUT

- Input range: 100 to 240 VAC
- Frequency: 50 to 60Hz
- Input current: $\leq 2.25A$
- Inrush current: $\leq 100A$ at cold start
- Efficiency: meets CEC level VI
- Hold up time: $\geq 8.3mS$
- Turn on time: $\leq 3s$

OUTPUT

- Over voltage protection: auto recovery
- Short circuit protection: auto recovery
- Over current protection: auto recovery

ENVIRONMENTAL

- Operating temperature: 0 to 40°C
- Storage temperature: -20 to 85 °C
- Storage humidity: 5% to 95%

SAFETY

- UL/CUL UL60950-1, EN/IEC60950-1, TUV, CB, CE, PSE, FCC, CCC

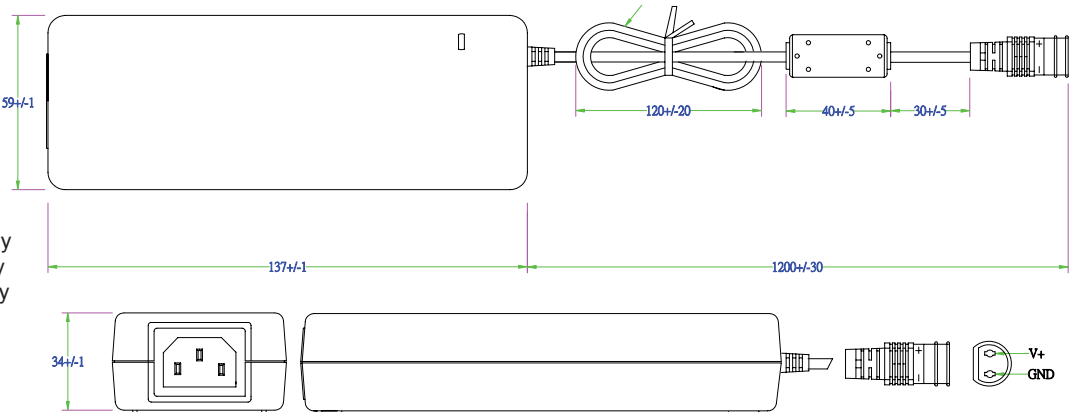

- Case Size: 137Lx59Wx34H (mm)
- Weight: 420g

4.75 / 1.75 / 11.00mm

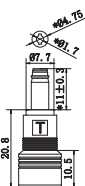

5.5 / 2.1 / 10.50mm

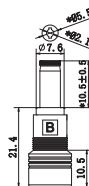

5.5 / 2.5 / 12.5mm

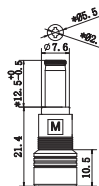

6.3 / 3.0 / 12.00mm

